

# CCE 25|30|35



## COMMERCIAL CUBIC

### CONSTRUCTION CHARACTERISTICS

- ~ 10 mm O.D. seamless copper tube expanded into aluminium fins. Stainless Steel tube on request
- ~ casing in white pre-coated aluminium or inox on request
- ~ 230V/1F/50Hz motorfans
- ~ on request:
  - protective treatment of coils
  - brine mode use

### DEFROST

- ~ AIR: "A" without defrost system
- ~ ELECTRIC: "E" stainless steel sheathed electric heaters, vulcanized terminals
- ~ SPECIAL: hot gas defrost

## COMMERCIALI CUBICI

### CARATTERISTICHE COSTRUTTIVE

- ~ *batteria realizzata con tubo di rame Ø 10 mm ed aletta di alluminio. A richiesta realizzazione con tubo in acciaio inox*
- ~ *involucro in alluminio pre verniciato bianco o inox su richiesta*
- ~ *motoventilatori 230V/1F/50Hz*
- ~ *a richiesta possibilità di:*
  - *trattamenti protettivi della batteria*
  - *funzionamento ad acqua glicolata*

### SBRINAMENTO

- ~ *ARIA: "A" senza sistema di sbrinamento*
- ~ *ELETTRICO: "E" a mezzo resistente corazzate in acciaio inossidabile con terminali vulcanizzati*
- ~ *SPECIALE: gas caldo in vari sistemi*

EC MOTORS  
AVAILABLE



by  
ebmpapst

| Model<br>Modello | Capacity<br>Resa<br>Tc=0°C<br>DT 8K | Capacity<br>Resa<br>Tc=-25°C<br>DT 6K | Air Flow<br>Portata<br>Aria | Air<br>Throw<br>Freccia<br>Aria | Surface<br>Superficie | Internal<br>Volume<br>Volume<br>Interno | Motorfans<br>Motoventilatori |                       |   | Electrical Defrost<br>Sbrinamento Elettrico |                  | Water<br>Defrost<br>Sbrina-<br>mento<br>Acqua | Sound<br>Pressure<br>Pressione<br>Sonora | Wei-<br>ght<br>Peso | Con-<br>nections<br>Connes-<br>sioni |                |
|------------------|-------------------------------------|---------------------------------------|-----------------------------|---------------------------------|-----------------------|-----------------------------------------|------------------------------|-----------------------|---|---------------------------------------------|------------------|-----------------------------------------------|------------------------------------------|---------------------|--------------------------------------|----------------|
|                  | SC2                                 | SC4                                   |                             |                                 |                       |                                         | Ø 250                        | Tensione 230V/1F/50Hz |   | Standard                                    | Enhanced         |                                               |                                          |                     |                                      |                |
| CCE 25           | kW                                  | kW                                    | m³/h                        | m                               | m²                    | dm³                                     | n°                           | W                     | A | rpm                                         | kW(@<br>230V/1F) | kW(@<br>230V/1F)                              | l/h                                      | dB(A) @<br>5m       | kg                                   | IN/OUT<br>Ø mm |

| Fin Space - 4 mm |      |      |      |    |    |   |   |     |      |      |   |      |   |        |    |         |
|------------------|------|------|------|----|----|---|---|-----|------|------|---|------|---|--------|----|---------|
| CCEH 251 S4      | 1,62 | 0,90 | 994  | 8  | 7  | 1 | 1 | 50  | 0,23 | 1380 | 1 | 0,00 | 0 | 34 / 5 | 10 | 10 / 10 |
| CCEH 251 S6      | 1,87 | 1,26 | 855  | 7  | 11 | 2 | 1 | 50  | 0,23 | 1380 | 1 | 0,00 | 0 | 34 / 5 | 12 | 12 / 22 |
| CCEH 252 S4      | 3,40 | 2,10 | 1987 | 9  | 15 | 2 | 2 | 100 | 0,46 | 1380 | 1 | 0,00 | 0 | 37 / 5 | 20 | 12 / 22 |
| CCEH 252 S6      | 4,22 | 2,64 | 1716 | 8  | 22 | 3 | 2 | 100 | 0,46 | 1380 | 2 | 0,00 | 0 | 37 / 5 | 24 | 12 / 22 |
| CCEH 253 S4      | 5,19 | 3,22 | 2977 | 9  | 22 | 3 | 3 | 150 | 0,69 | 1380 | 2 | 0,00 | 0 | 39 / 5 | 29 | 12 / 22 |
| CCEH 253 S6      | 6,49 | 4,01 | 2569 | 8  | 33 | 4 | 3 | 150 | 0,69 | 1380 | 3 | 0,00 | 0 | 39 / 5 | 36 | 12 / 22 |
| CCEH 254 S4      | 7,05 | 4,30 | 3970 | 9  | 29 | 3 | 4 | 200 | 0,92 | 1380 | 3 | 0,00 | 0 | 40 / 5 | 39 | 12 / 22 |
| CCEH 254 S6      | 8,65 | 5,45 | 3419 | 8  | 43 | 5 | 4 | 200 | 0,92 | 1380 | 3 | 0,00 | 0 | 40 / 5 | 49 | 16 / 22 |
| Fin Space - 6 mm |      |      |      |    |    |   |   |     |      |      |   |      |   |        |    |         |
| CCEH 251 M4      | 1,36 | 0,76 | 1041 | 9  | 5  | 1 | 1 | 50  | 0,23 | 1380 | 1 | 0,00 | 0 | 34 / 5 | 10 | 10 / 10 |
| CCEH 251 M6      | 1,67 | 1,09 | 904  | 8  | 7  | 2 | 1 | 50  | 0,23 | 1380 | 1 | 0,00 | 0 | 34 / 5 | 12 | 10 / 10 |
| CCEH 252 M4      | 2,79 | 1,74 | 2081 | 9  | 10 | 2 | 2 | 100 | 0,46 | 1380 | 1 | 0,00 | 0 | 37 / 5 | 20 | 12 / 22 |
| CCEH 252 M6      | 3,55 | 2,25 | 1807 | 8  | 15 | 3 | 2 | 100 | 0,46 | 1380 | 2 | 0,00 | 0 | 37 / 5 | 24 | 12 / 22 |
| CCEH 253 M4      | 4,24 | 2,71 | 3122 | 10 | 15 | 3 | 3 | 150 | 0,69 | 1380 | 2 | 0,00 | 0 | 39 / 5 | 29 | 12 / 22 |
| CCEH 253 M6      | 5,47 | 3,47 | 2718 | 8  | 22 | 4 | 3 | 150 | 0,69 | 1380 | 3 | 0,00 | 0 | 39 / 5 | 36 | 12 / 22 |
| CCEH 254 M4      | 5,69 | 3,67 | 4152 | 10 | 19 | 3 | 4 | 200 | 0,92 | 1380 | 3 | 0,00 | 0 | 40 / 5 | 39 | 12 / 22 |
| CCEH 254 M6      | 7,39 | 4,74 | 3618 | 9  | 29 | 5 | 4 | 200 | 0,92 | 1380 | 3 | 0,00 | 0 | 40 / 5 | 49 | 16 / 22 |
| Fin Space - 8 mm |      |      |      |    |    |   |   |     |      |      |   |      |   |        |    |         |
| CCEH 251 L4      | 1,20 | 0,66 | 904  | 8  | 4  | 1 | 1 | 50  | 0,23 | 1380 | 1 | 0,00 | 0 | 34 / 5 | 10 | 10 / 10 |
| CCEH 251 L6      | 1,36 | 0,85 | 775  | 7  | 5  | 2 | 1 | 50  | 0,23 | 1380 | 1 | 0,00 | 0 | 34 / 5 | 12 | 10 / 10 |
| CCEH 252 L4      | 2,40 | 1,46 | 2128 | 9  | 7  | 2 | 2 | 100 | 0,46 | 1380 | 1 | 0,00 | 0 | 37 / 5 | 20 | 12 / 22 |
| CCEH 252 L6      | 3,11 | 1,97 | 1859 | 8  | 11 | 3 | 2 | 100 | 0,46 | 1380 | 2 | 0,00 | 0 | 37 / 5 | 24 | 12 / 22 |
| CCEH 253 L4      | 3,62 | 2,32 | 3181 | 10 | 11 | 3 | 3 | 150 | 0,69 | 1380 | 2 | 0,00 | 0 | 39 / 5 | 29 | 12 / 22 |
| CCEH 253 L6      | 4,78 | 3,05 | 2788 | 9  | 16 | 4 | 3 | 150 | 0,69 | 1380 | 3 | 0,00 | 0 | 39 / 5 | 36 | 12 / 22 |
| CCEH 254 L4      | 4,91 | 3,16 | 4242 | 10 | 15 | 3 | 4 | 200 | 0,92 | 1380 | 3 | 0,00 | 0 | 40 / 5 | 39 | 12 / 22 |
| CCEH 254 L6      | 6,45 | 4,11 | 3717 | 9  | 22 | 5 | 4 | 200 | 0,92 | 1380 | 3 | 0,00 | 0 | 40 / 5 | 49 | 16 / 22 |

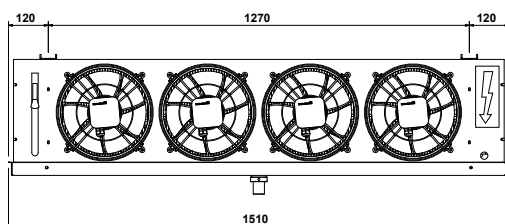
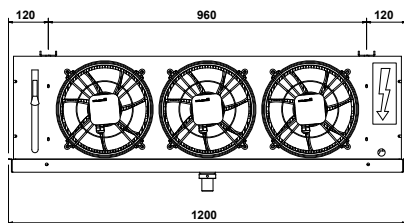
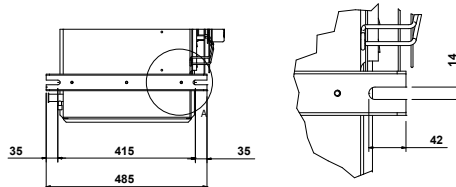
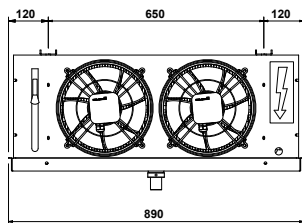
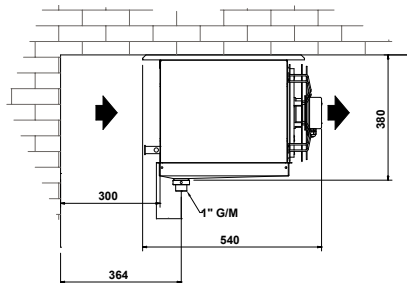
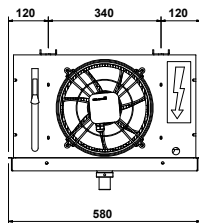

# CCE 25