

KDE 23



COMMERCIAL DUAL DISCHARGE

CONSTRUCTION CHARACTERISTICS

- ~ 8 mm O.D. seamless copper tube expanded into aluminium fins.
- ~ casing in white pre-coated aluminium or inox on request
- ~ wired 230V/1F/50Hz motorfans
- ~ protective treatment of coils on request

DEFROST

- ~ AIR: "A" without defrost system
- ~ ELECTRIC: "E" stainless steel sheathed electric heaters, vulcanized terminals
- ~ SPECIAL: hot gas defrost

COMMERCIALI DOPPIO FLUSSO

CARATTERISTICHE COSTRUTTIVE

- ~ batteria realizzata con tubo di rame Ø 8 mm ed aletta di alluminio.
- ~ involucro in alluminio pre verniciato bianco o inox su richiesta
- ~ motoventilatori 230V/1F/50Hz cablati
- ~ a richiesta possibilità di trattamenti protettivi della batteria

SBRINAMENTO

- ~ ARIA: "A" senza sistema di sbrinamento
- ~ ELETTRICO: "E" a mezzo resistente corazzate in acciaio inossidabile con terminali vulcanizzati
- ~ SPECIALE: gas caldo in vari sistemi

EC MOTORS
AVAILABLE



by
ebmpapst

Model Modello	Capacity Resa Tc=0°C DT 8K	Capacity Resa Tc=-25°C DT 6K	Air Flow Portata Aria	Air Throw Freccia Aria	Surface Superficie	Internal Volume Volume Interno	Motorfans Motoventilatori				Electrical Defrost Sbrinatorio Elettrico		Water Defrost Sbrina- mento Acqua	Sound Pressure Pressione Sonora	Wei- ght Peso	Con- nections Connes- sioni
	SC2	SC4					Ø 230	Tensione 230V/1F/50Hz			Standard	Enhanced				
								W	A	rpm	kW(@ 230V/1F)	kW(@ 230V/1F)				
KDE 23	kW	kW	m³/h	m	m²	dm³	n°	W	A	rpm	kW(@ 230V/1F)	kW(@ 230V/1F)	l/h	dB(A) @ 5m	kg	IN/OUT Ø mm

Fin Space - 4 mm																
KDE 231 S6	1,13	0,74	375	3	4	1	1	36	0,25	1300	1	0,00	0	45 / 5	9	12 / 22
KDE 232 S6	2,42	1,51	746	4	9	2	2	72	0,50	1300	1	0,00	0	47 / 5	14	12 / 22
KDE 233 S6	3,66	2,29	1116	4	13	2	3	108	0,75	1300	2	0,00	0	50 / 5	18	12 / 22
KDE 234 S6	4,95	3,07	1487	4	18	3	4	144	1,00	1300	2	0,00	0	51 / 5	23	12 / 22
KDE 235 S6	6,11	3,94	1859	4	22	4	5	180	1,25	1300	3	0,00	0	56 / 5	27	16 / 22
Fin Space - 6 mm																
KDE 231 M6	0,95	0,64	390	4	3	1	1	36	0,25	1300	1	0,00	0	45 / 5	9	8 / 8
KDE 232 M6	2,05	1,3	780	4	6	2	2	72	0,50	1300	1	0,00	0	48 / 5	14	12 / 22
KDE 233 M6	3,13	2,01	1172	4	9	2	3	108	0,75	1300	2	0,00	0	50 / 5	18	12 / 22
KDE 234 M6	4,24	2,64	1560	4	12	3	4	144	1,00	1300	2	0,00	0	51 / 5	23	12 / 22
KDE 235 M6	5,26	3,32	1950	4	15	4	5	180	1,25	1300	3	0,00	0	52 / 5	27	16 / 22

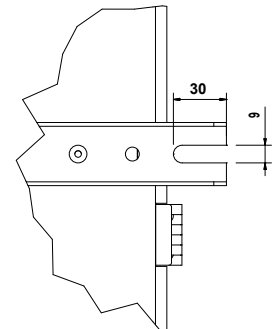
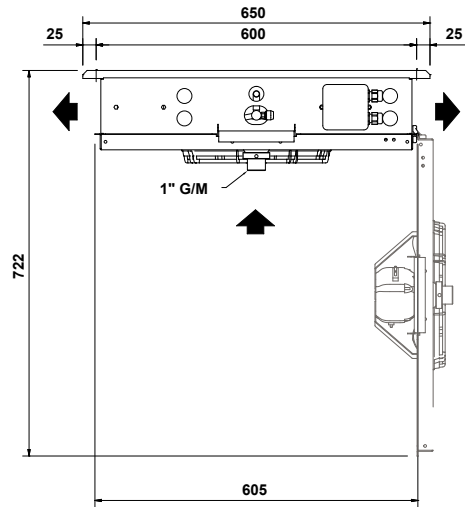
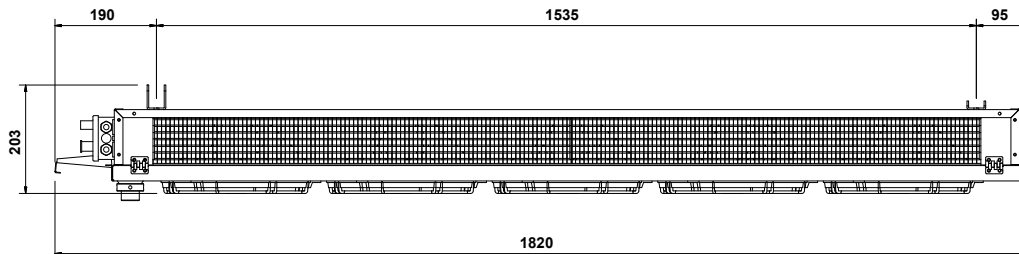
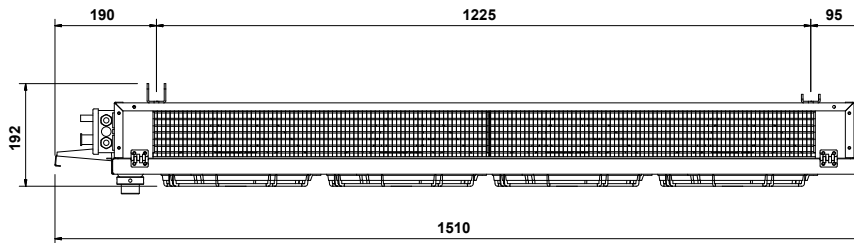
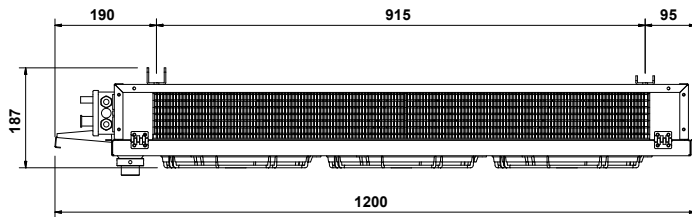
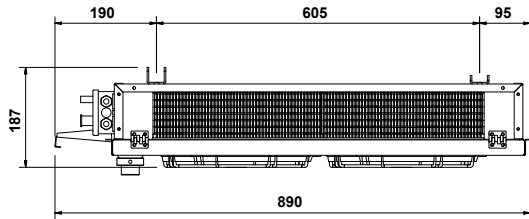
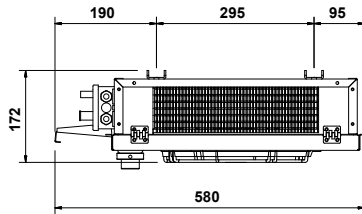

KDE 23